

maia[®]

innovation in worksurface technology

Jointing and Edging Instructions



All aspects of the installation of maia are also covered in a DVD that is available to view on-line at www.maiaworksurfaces.co.uk

These instructions should be used in conjunction with the full care & maintenance manual which is supplied with your worktops and can also be downloaded at www.maiaworksurfaces.co.uk

Joining the worksurface

1. Use a router and 12mm cutter with a straight edge to cut the female worksurface to the desired length.
2. To produce the 13mm groove for the loose tongues (supplied) use the straight edge of the mitre jig and the 3mm groover



3. Set the groover to score the underside of the solid surface.

Care should be taken once the groove has been machined not to place pressure on the unsupported solid surface.

4. Stop groove 3mm from front edge.
5. Using the isopropyl alcohol wipe supplied in the joint kit, clean the inside of the grooves and the loose tongues.

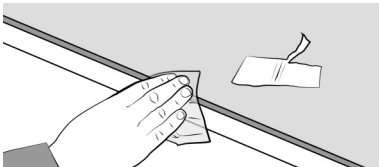

Ensure all surfaces are clean dry and free of debris and dirt including the surrounding areas before proceeding to the next stage.

6. Position two layers of masking tape approx. 3mm from the edge of each joint line.

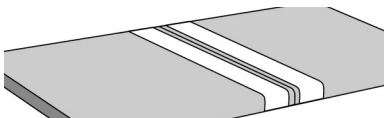

7. It is essential that the joint is dry fitted before bonding, to check it has been machined correctly. The chipboard surface may need block sanding to ensure any protruding fibres are removed. This will ensure that the two machined edges will draw together flush.

The tongues must be inserted during the dry-fit; this will act as a check that the groove has been machined to the correct depth.

8. Ensure that the appropriate adhesive colour for the worksurface décor is being used.

It is recommended that disposable gloves are worn when handling adhesive.

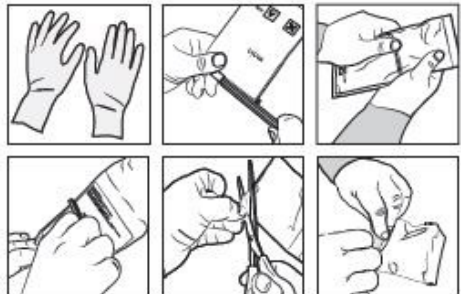

Mix the adhesive as per the instructions with the pack.

9. Position the first worksurface onto the base units and apply a coating of the 2-part acrylic adhesive into the groove of the first board and insert the loose tongues (2 for 600mm tops, 3 for 900mm tops.)

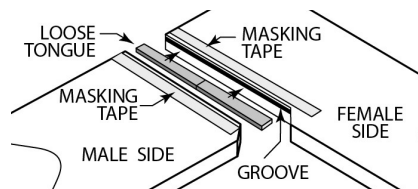

- Apply adhesive into the groove of the second board and the chipboard underneath the tongue.

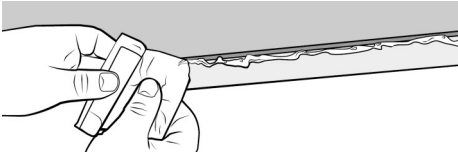

- Pull the worksurfaces together leaving a gap of approximately 5mm and apply a further bead of adhesive along the gap and into the front edge of the joint.

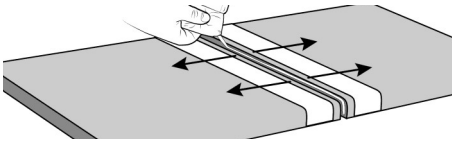

- Ensure the surfaces are level and tighten together using a worksurface connecting bolts with a 10mm spanner.

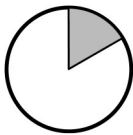
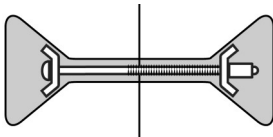

NB The working time of the adhesive once mixed is around 8-10 minutes depending on ambient temperature.

- Before the adhesive starts to cure, bridge the strips of masking tape lightly with a spatula or scraper and remove excess adhesive.

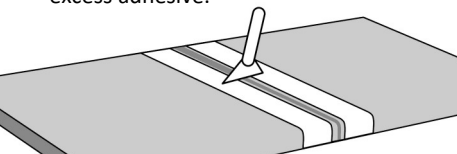

- Ensure masking tape is removed before adhesive cures leaving a small bead line.

- The hardening time of the adhesive depends on the ambient temperature and the amount of adhesive applied.
- The hardening can be checked with a fingernail or by checking the adhesive in the sachet.

- Once cured, the bead of adhesive can be removed by sanding with a random orbital sander with the following order of sandpaper grades: P120 to remove the adhesive bead, P240, P320 and then finish with a red abrasive pad and a light mist of water. All stages must be carried out with the random orbital sander.



- Ensure that dust is removed between sanding processes.
- Sand across, up and down then across, up and down in a north—south, east—west style.

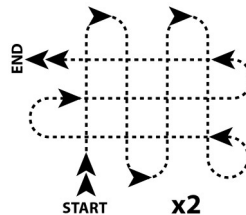

- When changing the sandpaper grade, increase the sanding area slightly to blend in.

Edging Strip Application

1. Cut the worksurface to length +5mm using a saw.
2. Trim to exact size using a router to ensure the edge is clean and straight.
3. All bonding surfaces should be cleaned with the isopropyl alcohol wipe supplied and then should no longer be touched with bare hands.
4. The acrylic adhesive is applied to the edge strip or the substrate as illustrated.

To ensure an even spread of the adhesive, when offering the edge strip to the cut edge slide the edging side to side before taping into position.

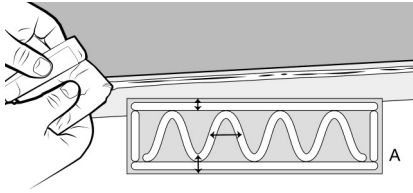

Adhesive application for edging strips

5. Apply the adhesive as above (A) and push the edging into place with two strips of masking tape to hold in position. Align edging to the bottom edge of the worktop.

6. Firmly tape lengths of 2" masking tape approximately 2" apart along the length of the edging so that excess adhesive oozes out above and below the edging

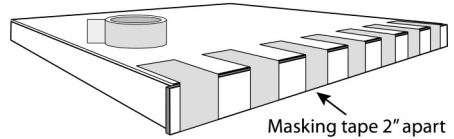

7. Do not remove the masking tape until the adhesive has cured as doing so may pull the edging away from the worksurface.
8. After the adhesive has cured, trim off flush to all surfaces with a random orbital sander using P120 to remove the adhesive and any overhang of surface material, P240, P320 and then finish with red abrasive pad and a light mist of water.