

## EM05LH

Minimalist Deep 1.5 Bowl  
and Drainer Inset Steel  
Sink



### Features

- Lifetime Warranty. T&C's Apply
- UKCA & CE Approved.
- 1000mm x 520mm overall size,  
206mm "DEEP" main bowl
- LH drainer available
- SS304 (0.8mm) steel
- Supplied complete with waste,  
hygienic overflow and fitting clips
- Minimum cabinet width required 600mm
- Waste disposal compatible
- Hot water tap compatible

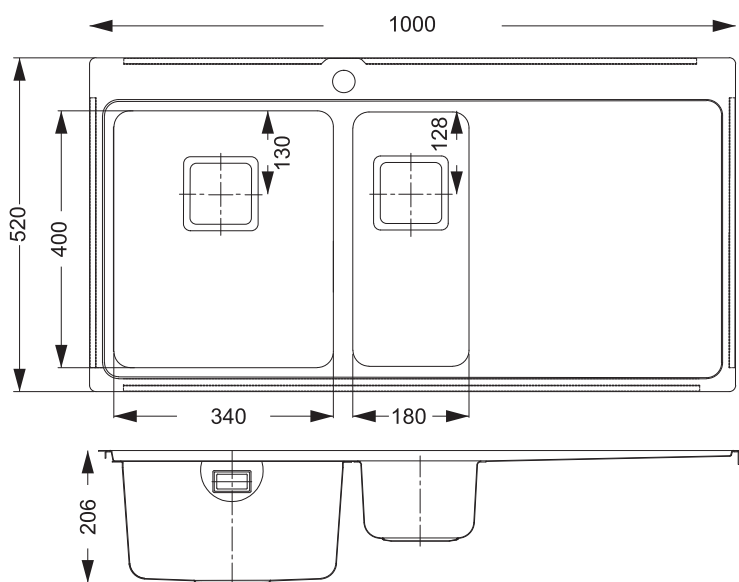

### Compatible Waste Kit

UKH010

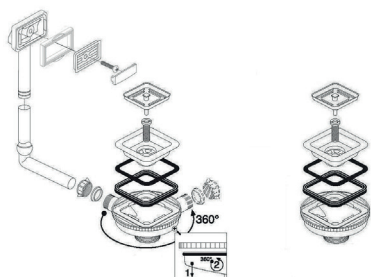

### Compatible Plumbing Kits

UKH040

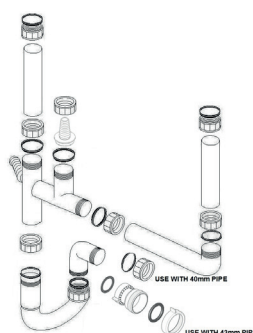

UKH061

